

PINO

DIN EN 22339
ANTIGO DIN 1

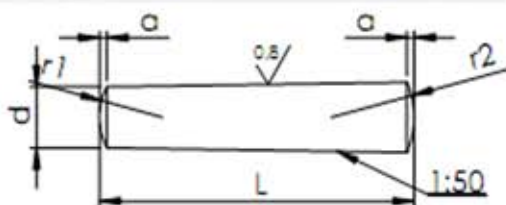

dh10	3	4	5	6	8	10	12
a	0,4	0,5	0,63	0,8	1	1,2	1,6
comprimento L	14	Yellow	Dark Blue	Dark Blue	Dark Blue	Dark Blue	Dark Blue
	15	Yellow	Dark Blue	Dark Blue	Dark Blue	Dark Blue	Dark Blue
	16	Yellow	Dark Blue	Dark Blue	Dark Blue	Dark Blue	Dark Blue
	18	Yellow	Dark Blue	Dark Blue	Dark Blue	Dark Blue	Dark Blue
	20	Yellow	Dark Blue	Dark Blue	Dark Blue	Dark Blue	Dark Blue
	22	Yellow	Dark Blue	Dark Blue	Dark Blue	Dark Blue	Dark Blue
	24	Yellow	Dark Blue	Dark Blue	Dark Blue	Dark Blue	Dark Blue
	26	Yellow	Dark Blue	Dark Blue	Dark Blue	Dark Blue	Dark Blue
	28	Yellow	Dark Blue	Dark Blue	Dark Blue	Dark Blue	Dark Blue
	30	Yellow	Dark Blue	Dark Blue	Dark Blue	Dark Blue	Dark Blue
	32	Yellow	Dark Blue	Dark Blue	Dark Blue	Dark Blue	Dark Blue
	35	Yellow	Dark Blue	Dark Blue	Dark Blue	Dark Blue	Dark Blue
	40	Yellow	Dark Blue	Dark Blue	Dark Blue	Dark Blue	Dark Blue
	45	Yellow	Dark Blue	Dark Blue	Dark Blue	Dark Blue	Dark Blue
	50	Yellow	Dark Blue	Dark Blue	Dark Blue	Dark Blue	Dark Blue
	55	Dark Blue	Dark Blue	Dark Blue	Dark Blue	Dark Blue	Dark Blue
	60	Dark Blue	Dark Blue	Dark Blue	Dark Blue	Dark Blue	Dark Blue
	65	Dark Blue	Dark Blue	Dark Blue	Dark Blue	Dark Blue	Dark Blue
	70	Dark Blue	Dark Blue	Dark Blue	Dark Blue	Dark Blue	Dark Blue
	75	Dark Blue	Dark Blue	Dark Blue	Dark Blue	Dark Blue	Dark Blue
80	Dark Blue	Dark Blue	Dark Blue	Dark Blue	Dark Blue	Dark Blue	
85	Dark Blue	Dark Blue	Dark Blue	Dark Blue	Dark Blue	Dark Blue	
90	Dark Blue	Dark Blue	Dark Blue	Dark Blue	Dark Blue	Dark Blue	
95	Dark Blue	Dark Blue	Dark Blue	Dark Blue	Dark Blue	Dark Blue	
100	Dark Blue	Dark Blue	Dark Blue	Dark Blue	Dark Blue	Dark Blue	
120	Dark Blue	Dark Blue	Dark Blue	Dark Blue	Dark Blue	Dark Blue	
140	Dark Blue	Dark Blue	Dark Blue	Dark Blue	Dark Blue	Dark Blue	
160	Dark Blue	Dark Blue	Dark Blue	Dark Blue	Dark Blue	Dark Blue	
165	Dark Blue	Dark Blue	Dark Blue	Dark Blue	Dark Blue	Dark Blue	

MATERIAL - AÇO 1050